







Anya

Ref. AIT430DB

Luminario de sobreponer en techo, fabricado en fundición de aluminio inyectado a presión, color blanco, reflector color negro. Difusor transparente. LED marca CREE. Driver dimeable por DALI.



| | | | | |
|---|--|---|---|---|
|  |  | 110-277 Vca 50/60 Hz | UGR <25 | Seguridad Fotobiológica 1 |
| IP 20 |  |  |  |  |

Dimensiones

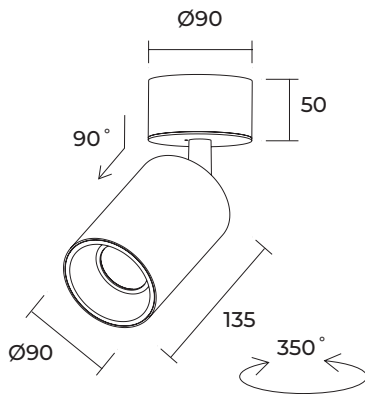

Características técnicas

| | | | |
|----------|-------------|-------|--------------------|
| 2243 lm | Lúmenes | 50000 | Horas de vida útil |
| 3000 K | Temperatura | 0,95 | Factor de Potencia |
| 28 W | Potencia | 92 | Rendimiento (%) |
| 0.410 Kg | Peso | 90 | CRI |
| | | 3 | Años de garantía |

Instalación: Fijar la base a techo, cablear y colocar el luminario a presión en la base.

Datos fotométricos

